

159/13

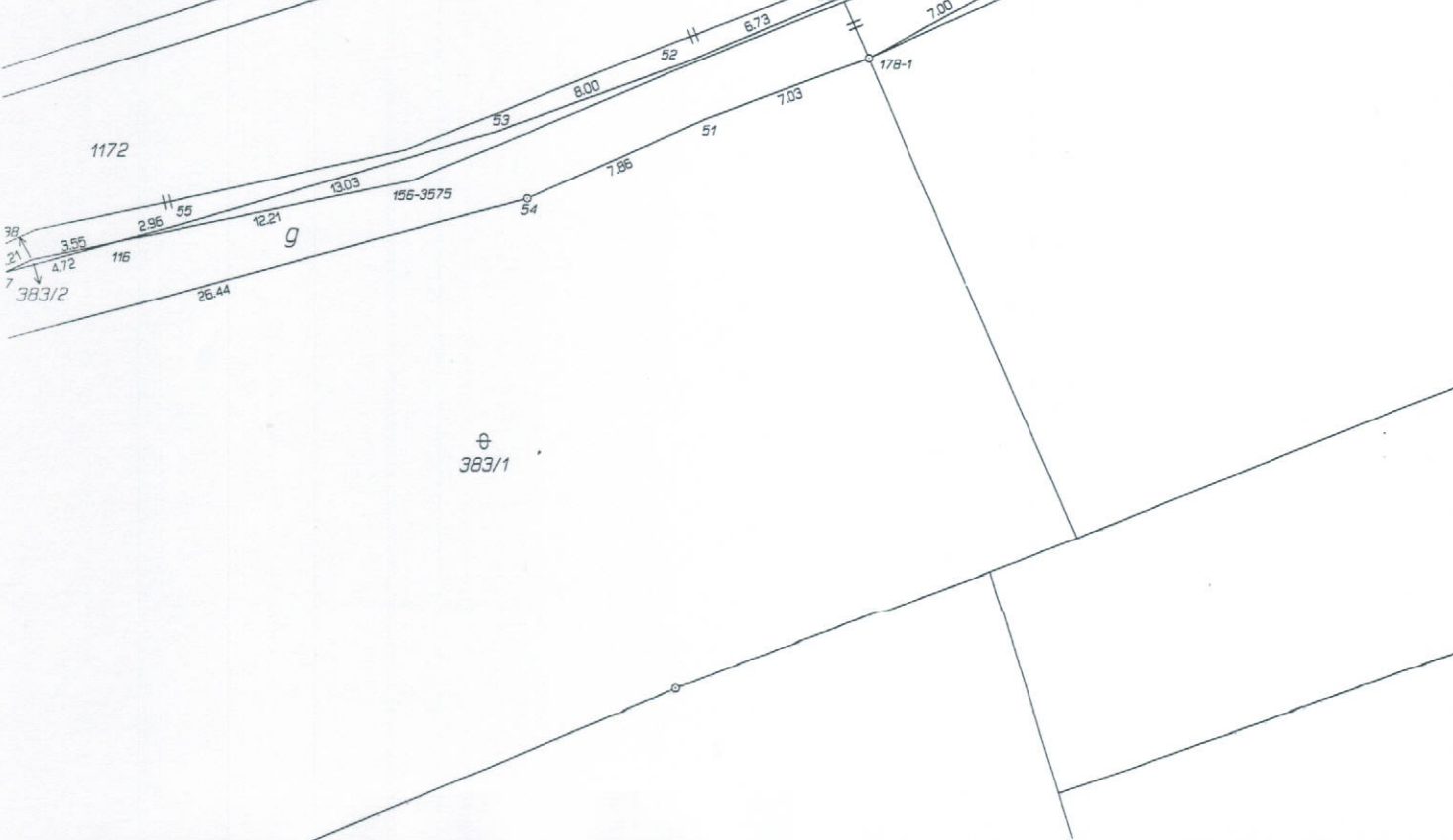
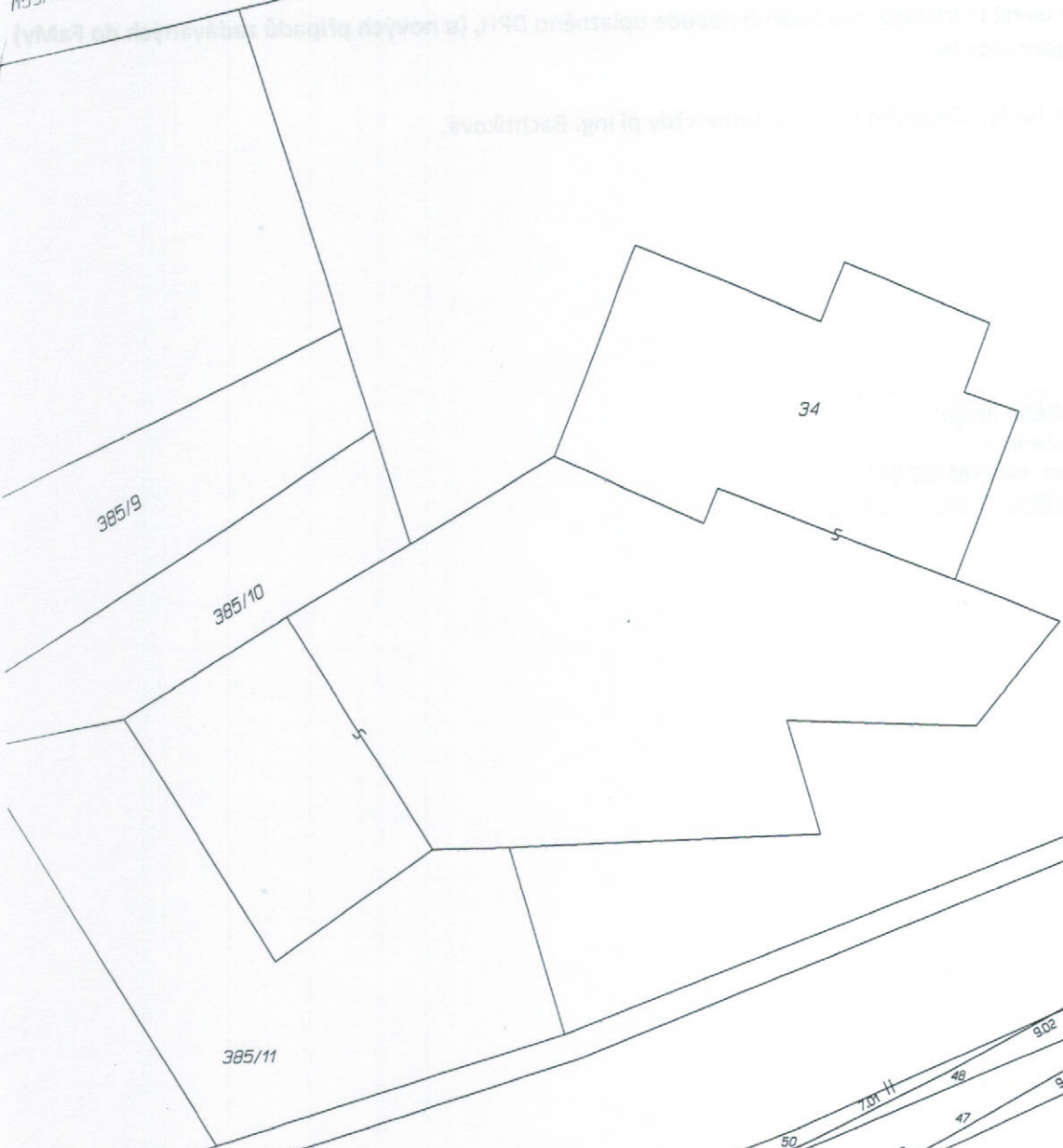

⊕  
383/1

383/2

1172

g

156-3575

178-1

2016/6

378/3

34

385/9

385/10

385/11

38

21

7

116

26.44

3.55

4.72

2.96

55

12.21

13.03

5.4

7.86

51

7.03

50

8.73

8.00

52

7.01

48

7.00

47

9.02

45

9.02

45

18.03

2.96

18.03



⊕  
347/3

1159/17

11  
389/1

11  
393/2

2016/13

Detail "B"

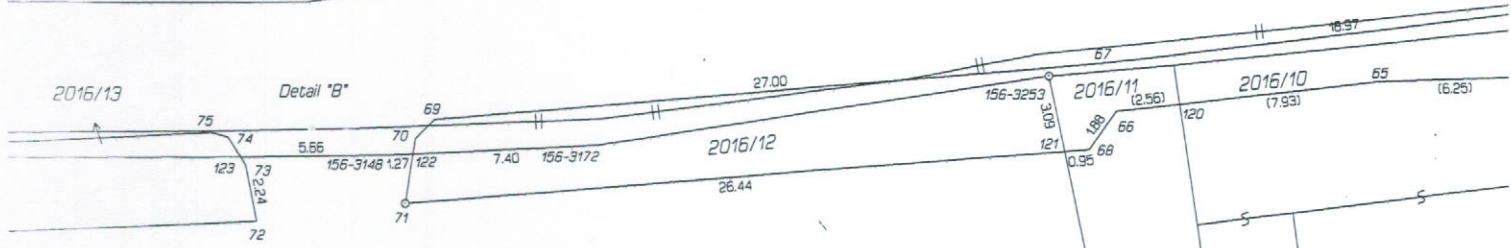

Detail "B"

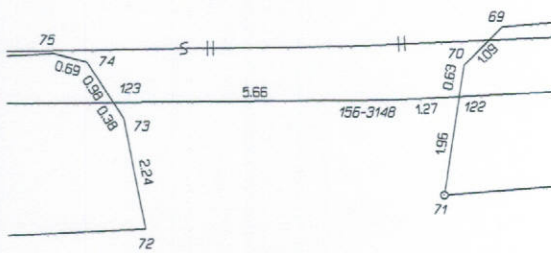

393/1

393/11

156-3284

118



II  
289/1

103

1159/3 →

156-2110

174  
134

13.25

p

100

101

3.05

102

2.96

103

3.93

Detail "D"

104

105

133

105

6.28

8.55

6.58

1122

II  
289/3

⊕  
285/3

II  
283/1

II  
238/3

